

**FREE AIR  
OR EXTENSION**  
BOOK BY JULY 31, 2017

 COMMONWEALTH CLUB

# COSTA RICA & THE PANAMA CANAL

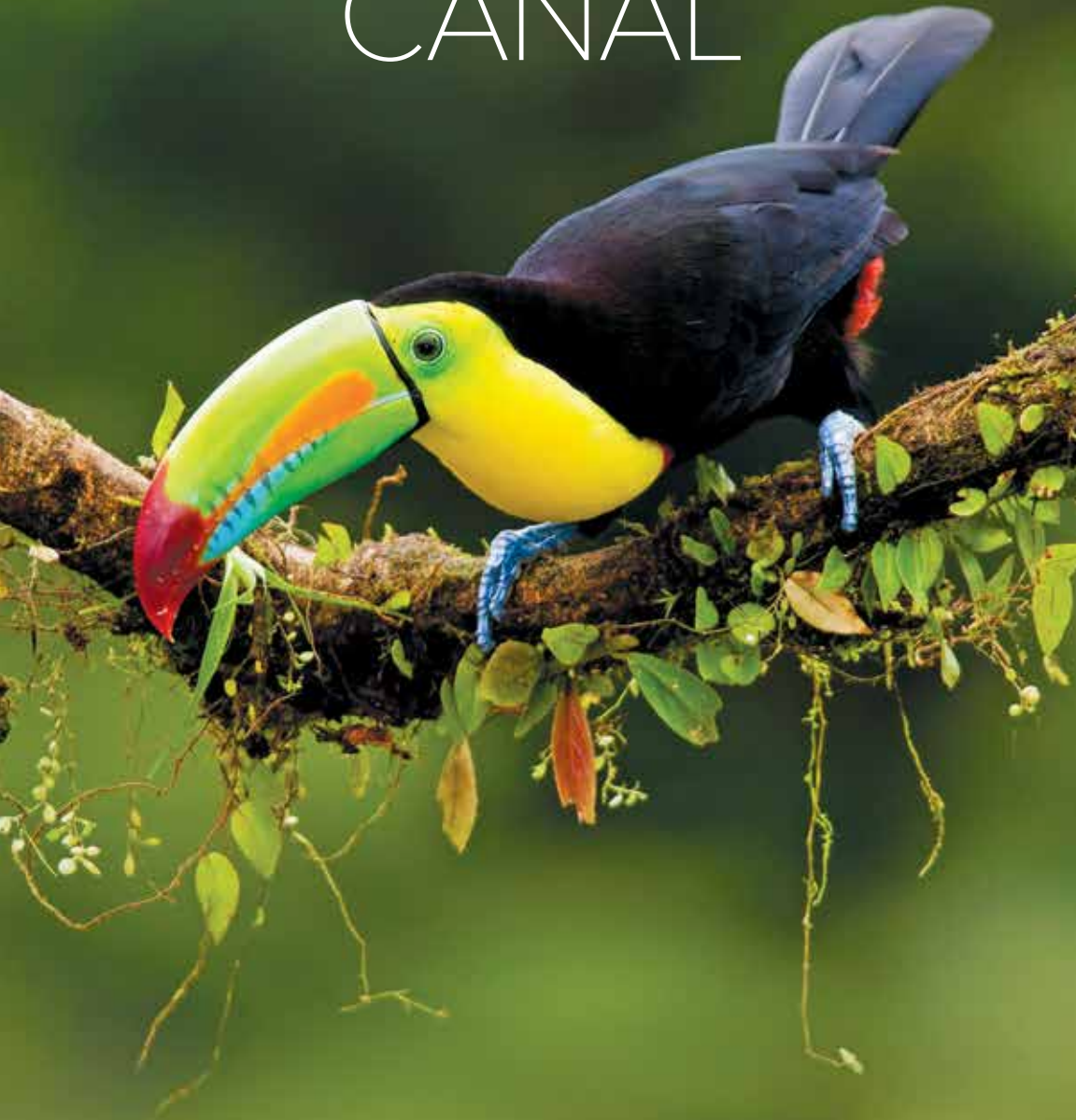

JANUARY 13-20, 2018 | ABOARD NATIONAL GEOGRAPHIC QUEST





## DEAR COMMONWEALTH CLUB MEMBER,

Transiting the Panama Canal is a life list must-do for many. And with the recent historic opening of the locks, there's no better time to experience this remarkable achievement of human engineering. On their own, the locks—which move 26 million gallons of water, lifting ships up 85 feet above sea level—are well worth the visit. However, the Canal is also home to 48 miles of incredible wildness. Some travelers who expect only to find steel and concrete are delightfully surprised by its riches in biodiversity and rain forests.

Our two-day transit of the Canal is unique, and you'll enjoy exclusive arrangements that are key to appreciating it fully. Experience the Canal by day and dramatically lit by night, and visit the Smithsonian Biological Research Institute at Barro Colorado Nature Monument for hikes and tours by Zodiac. To take full advantage of Panama, consider joining the special optional extension, with an overnight, in Panama City. You'll stop at the Agua Clara Visitor Center for a view of the new locks, visit the new Frank Gehry-designed Biodiversity Museum, and see Casco Viejo, the city's Old Quarter.

Then, leave the man-made behind, to explore spectacularly wild stretches of Panama and Costa Rica. Count on being highly active, with options for every fitness level. Hike to a waterfall, take a rain forest walk, explore mangroves by Zodiac or make landfall on pristine beaches, kayak along the shores of wild islands, enjoy paddleboarding in warm tropical waters, or snorkel to see the undersea. The ship's tools let you experience diverse habitats with all your senses—and the monkeys, sloths, toucans, macaws, butterflies, hummingbirds, and more that inhabit them.

You'll have the special opportunity to sail aboard the brand-new 100-guest *National Geographic Quest*. This state-of-the-art expedition ship features gracious details—open decks, step-out balconies, spacious cabins, large view windows, an accommodating bow observation area—that will greatly enhance your voyage. You'll find the top experts—naturalists, biologists, undersea specialists aboard—will help you see, do, and learn more. And you'll benefit from the National Geographic photographer and Lindblad-National Geographic certified photo instructor, who help you capture it all in your best photos ever.

Few have the opportunity to experience the Canal and the rare wildness of Costa Rica the way you will on this exceptional expedition. I hope you are inspired to join us. **To make your reservation, please return the attached reservation form. For questions, please call 415-597-6720 or e-mail [travel@commonwealthclub.org](mailto:travel@commonwealthclub.org).**

Sincerely,



Kristina Nemeth  
Travel Director

**P.S. Book by July 31, 2017 and receive free round-trip airfare between Miami and Panama City/Costa Rica, OR a free overnight and sightseeing in Panama City.**

*Cover: Keel-billed toucan, Costa Rica. ©Bill Gozansky*

*Opposite page: Discover hidden waterfalls during naturalist-led hikes. ©Ralph Lee Hopkin.*

*Ship's registry: United States*



# DISCOVER THE BREADTH OF BIODIVERSITY

Costa Rica and Panama are two of the most beautiful and wildly diverse natural places on the planet. The region is home to iconic wildlife—brilliant macaws, howler and capuchin monkeys, sloths, vibrantly colored butterflies, and strange frogs as well as thousands of species of flora, including dazzling orchids.



*At Barro Colorado Nature Monument, learn more about the National Geographic-funded projects to study the island's species.*

Traveling by expedition ship ensures you the most holistic way to experience the rain forests, beaches, idyllic isles, plus the historic Canal. Your 100-guest ship, equipped with Zodiacs, kayaks, stand-up paddleboards, and snorkeling gear, is key to experiencing all the region's variety and diversity. Venture up a winding rain forest river aboard a Zodiac. Explore the shoreline of a remote isle by kayak and snorkel a vibrant undersea garden. Cool off in the pool of a secluded waterfall as a reward after a hike in the jungle or spend a relaxing afternoon paddleboarding. Hundreds of species of mammals and birds live here, and the expedition team will teach you how to spot them hidden in the dense forest canopy—how to experience the sounds, silence, and beauty of the rain forest.

## A DEEPER & RICHER PANAMA CANAL TRANSIT

Stretching about 48 miles, the Panama Canal changed the way the world traveled and moved goods. Crossing it by ship is a life-list must—and your Canal transit offers the best possible experience. You'll cross over two days, allowing you to see the workings of the locks by day—and also dramatically lit at night, a highlight of the expedition for many. And you overnight in the Canal Zone on the lushly fringed Gatún Lake to visit Barro Colorado Nature Monument, site of the Smithsonian Tropical Research Institute that has been in continuous operation since 1923.

*Opposite page (clockwise from top): Blue Morpho butterfly; rare resplendent quetzal sighting in Costa Rica; guests observe the Panama Canal dramatically lit at night; scarlet macaw; howler monkey.*



# EXPERIENCE WILDNESS IN COMFORT & STYLE



*The lounge, with 270° views, is the hub of the expedition community.*

Life aboard the brand-new expedition ship *National Geographic Quest* is warm and welcoming. Handsomely appointed cabins with expansive windows provide a perfect haven after an active day of exploring. The lounge, the center of life aboard, accommodates the nightly recap—a convivial gathering of the expedition community to revisit the day's events and

swap stories over hors d'oeuvres and cocktails. And the casual dining room serves delicious, regional cuisine, sourced locally whenever possible. Enjoy line-caught fish in ceviche and other dishes, superb Costa Rican coffee, and more. From the ship's gracious amenities to the hotel staff's attentive service, *Quest* sets new standards for expedition comfort and hospitality.

## COOL TOOLS FOR ACTIVE EXPLORATION

*National Geographic Quest* is the perfect platform for exploring, self-sufficient with a suite of cool tools aboard. A fleet of Zodiacs lets you venture far from tourist infrastructure to explore remote, jungle-framed beaches. Kayaks let you experience wildness, personally, at water level—explore



*Guests exploring by Zodiac.*

mangroves or paddle along an idyllic beach. Snorkeling equipment, a video microscope, hydrophone, and an underwater bow cam let us see the undersea life we'd otherwise miss. And now a fleet of paddleboards invite everyone, from rookies to pros, to get exercise by exploring peaceful waters. Count on being active, with options for every fitness level.

*Opposite page (clockwise from top): Guest photographs waterfall, Corcovado National Park; guests try stand-up paddleboarding; kayaking is a great way to explore; take advantage of the many opportunities to snorkel.*





# ENHANCE YOUR EXPEDITION WITH A TOP TEAM

Your Costa Rica and Panama expedition team is comprised of engaging naturalists, photographers, undersea specialists, and filmmakers. They live and breathe life in the tropics and are the key to helping you learn, see, and do more. Your team consists of an expedition leader and four naturalists, including a Lindblad-National Geographic certified photo instructor to provide in-the-field instruction. Additionally, a wellness specialist leads aerobic hikes, morning stretch class, and offers spa treatments. And a video chronicler aboard films the story of your adventure to provide you with a lasting record of your unique expedition.



*Naturalists are always on hand to point out wildlife.*

## BENEFIT FROM EXPEDITION PHOTOGRAPHY



*Guest wildlife spotting.*

Unique in the world of travel, the Expedition Photography program offers guests of every skill and interest level unrivaled photography opportunities. You'll travel with a Lindblad-National Geographic certified photo instructor, a naturalist with a talent for photography, who has undergone special training—to assist you with your camera settings, the basics of composition, and to provide in-the-field tips. He or she will help

inspire you to capture the incredible wildlife and scenery you'll see daily. Plus, onboard slideshows and photo-sharing presentations radiate the fun. So whether you use a smartphone, point-and-shoot, or a sophisticated DSLR, count on returning home with improved skills and your best shots ever.

*Opposite page (clockwise from top): Three-toed sloths; guests take advantage of photography opportunities; an afternoon hike on a jungle trail; Zodiac cruise along a rain forest tributary; photographing Corcovado National Park; hummingbird sipping nectar.*

# COSTA RICA & THE PANAMA CANAL

ITINERARY: 8 DAYS/7 NIGHTS – NATIONAL GEOGRAPHIC QUEST



Scarlet macaws, Costa Rica.

Immerse yourself in natural wonders along the Pacific coast of Panama and Costa Rica on a voyage aboard *National Geographic Quest*. Venture into the forests of Manuel Antonio and Corcovado National Parks; search for monkeys, frogs, sloths, and brightly colored birds; or take an optional horseback ride on a pristine beach. A highlight of your voyage will be a crossing of the legendary Panama Canal.

## **DAY 1: U.S./SAN JOSÉ, COSTA RICA/HERRADURA/EMBARK**

Upon arrival in San José, transfer by land to Herradura and embark *National Geographic Quest*. (D)

## **DAY 2: MANUEL ANTONIO NATIONAL PARK**

Spend the morning in Manuel Antonio National Park, a UNESCO World Heritage site, where thick forests fringe white-sand beaches. Watch for three-toed sloths lazing among the branches, and spot monkeys and vividly colored birds. This afternoon follow the Pacific coastline south and stop for a refreshing swim or a hike. (B,L,D)

## **DAY 3: OSA PENINSULA**

Anchor off the Osa Peninsula to see some of the most pristine lowland rain forest on the Pacific coast. In the environs of Corcovado National Park, swim in waterfall pools, enjoy optional horseback riding on the coast, or trek through the rain forest for a chance to see four species of monkeys—howler, spider, capuchin, and squirrel. (B,L,D)



#### **DAY 4: GOLFO DULCE**

Enter the mangrove-fringed Golfo Dulce along the southwestern edge of Costa Rica. Visit Casa Orquídeas, a tropical paradise of ornamental palms, bromeliads, heliconias, and orchids, closed to the general public and reached by boat only. Keep your eye out for tanagers, parrots, and toucans. Later, explore the placid bay, ideal for kayaking, stand-up paddleboarding, Zodiac rides, and swimming. (B,L,D)

#### **DAY 5: COIBA NATIONAL PARK, PANAMA**

The first stop in Panama this morning is at the remote Isla Coiba, one of the many islands of Coiba National Park, a UNESCO World Heritage site. Once a penal colony, the island has long been protected and accessible by special permit only. Among its many endemic species are the Coiba Island agouti and the mantled howler monkey, as well as four varieties of sea turtle. Discover rich marine life while snorkeling, go kayaking or hiking, try stand-up paddleboarding, or simply relax on the beach. (B,L,D)

#### **DAY 6: GULF OF PANAMA ISLETS/PANAMA CANAL TRANSIT**

Today, explore the tiny islets of the Gulf of Panama by Zodiac or kayak. Here you might spot frigatebirds, brown pelicans, neotropical cormorants, and brown boobies. Set sail for the Panama Canal this afternoon. Stretching more than 50 miles, the Canal was a colossal engineering feat completed in 1914. It is still traversed by some 14,000 ships every year. As cargo ships tend to pass through the canal during the day, we'll most likely begin our crossing at night, when the canal is dramatically lit. (B,L,D)

#### **DAY 7: GATÚN LAKE/PANAMA CANAL TRANSIT**

Board Zodiacs to visit Barro Colorado Nature Monument in Gatún Lake by special arrangement. Scientists have worked at the Smithsonian Tropical Research Institute here since 1923, studying its 120 mammals and diverse tree species. It is also the site of a National Geographic–supported project that tracks tagged animals using automated radio signals and wireless technology. Join local guides for a walk through the forests. This evening, continue through the complex lock system of the Canal. (B,L,D)

#### **DAY 8: COLÓN/PANAMA CITY/U.S.**

After breakfast, disembark in Colón and transfer to the airport in Panama City for your flight home. (B)

#### **OPTIONAL EXTENSIONS**

**POST-VOYAGE (1 NIGHT/2 DAYS):** Visit Panama City's Agua Clara Visitor Center to observe the new locks, the Biodiversity Museum, and the World Heritage site of Casco Viejo.

**PRE-VOYAGE (7 NIGHTS/7 DAYS):** Explore Costa Rica's spectacular Monteverde Cloud Forest, Arenal Volcano, and Tortuguero. Call for details.

**NEW SHIP**



# NATIONAL GEOGRAPHIC QUEST

**CAPACITY:** 100 guests in 50 cabins.

**REGISTRY:** United States. **OVERALL LENGTH:** 238 feet.

The *National Geographic Quest* is the latest addition to the Lindblad-National Geographic fleet. Designed with over 50 years of expedition heritage, *Quest* is able to explore the same remote locations while setting a new standard in comfort and style.

**PUBLIC AREAS:** Global gallery; fitness center; LEXspa; lounge with full service bar and facilities for films and presentations; observation deck; mudroom with lockers for expedition gear, and a partially covered sundeck with chairs and tables. The “open bridge” provides guests an opportunity to meet the officers and captain and learn about navigation.

**MEALS:** Served in single seatings with unassigned tables for an informal atmosphere and easy mingling. Breakfast is a wide selection buffet and dinner is served family-style. Menu emphasizes local fare.

**CABINS:** All cabins face outside with windows or portholes, private facilities, and climate controls. Category 4 cabins have step-out balconies.

**EXPEDITION EQUIPMENT:** A fleet of 9 Zodiacs and 24 kayaks, Remotely Operated Vehicle (ROV), hydrophone, Splash-Cam, underwater video camera, video microscope, and paddleboards.

**SPECIAL FEATURES:** Guest Internet access, elevator, National Geographic photographer, Lindblad-National Geographic certified photo instructor, video chronicler, undersea specialist, and ship’s doctor.

**WELLNESS:** The vessel is staffed by a wellness specialist and features a gym with an elliptical machine, treadmill, exercycles, handweights, and resistance bands. Treatments in the LEXspa are available by appointment.

Prices are per person, double occupancy unless indicated as solo.

ITINERARY	CAT. 1	CAT. 2	CAT. 3	CAT. 4	CAT. 5 SUITE	CAT. 1 SOLO	CAT. 2 SOLO	ADVANCE PAYMENT	SAMPLE AIRFARES
Costa Rica & the Panama Canal	\$5,990	\$6,590	\$6,990	\$7,790	\$8,690	\$8,990	\$9,890	\$750	Miami/San José/ Panama City/Miami: Economy from \$460; Business from \$880. Subject to change.

**CATEGORY 1:** Main Deck #301-306

Cabins feature two lower single beds that can convert to a Queen, a writing desk, and two portholes.

**CATEGORY 2:** Main Deck #307-315

Cabins feature two lower single beds that can convert to a Queen, a writing desk, and two portholes.

**CATEGORY 3:** Upper Deck #201-206

Cabins feature two lower single beds that can convert to a Queen, a writing desk, and two large view windows.

**CATEGORY 4:** Upper Deck #207-229

Cabins feature two lower single beds that can convert to a Queen, a writing desk, sliding glass door, and small, private balcony.

**CATEGORY 5 (SUITE):** Observation Deck #101-108

Cabins feature two lower single beds that can convert to a Queen, large view windows, an expanded bathroom, writing desk, ample storage space, and a convertible sofa bed to accommodate a third person.

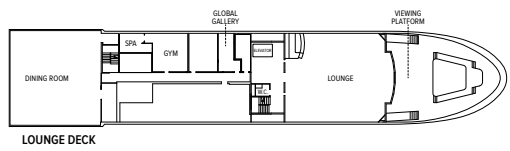
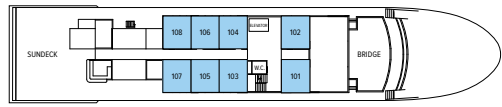

**NOTE:** Sole Occupancy cabins are available in Categories 1 and 2 only. Third person rates are available in Category 5 cabins at one half the double occupancy rate.

**Connecting Cabins via internal doorway access:** Main Deck: #312-314, #311-315, #306-308, #305-307; Upper Deck: #224-226, #225-227



*Clockwise from top left: Category 4 cabin with lower single beds converted to a Queen and private balcony; the dining room has unassigned seating for easy mingling; spacious Category 5 cabin on the Observation Deck; the sun deck is a perfect place to relax.*

# INCLUSIVE PRICING

## ABOARD SHIP

- ✓ All meals & nonalcoholic beverages
- ✓ 24-hour coffee, tea & soda on demand
- ✓ Hors d'oeuvres & snacks during nightly recap
- ✓ Environmentally friendly refillable water bottle
- ✓ Fully stocked library
- ✓ Exercise equipment
- ✓ The guidance & company of the expedition staff

## ASHORE

- ✓ Special access permits, park fees, port taxes
- ✓ Transfers to & from group flights
- ✓ The expertise of the expedition staff

## ACTIVITIES

- ✓ All shore activities
- ✓ Zodiac explorations
- ✓ **Kayaking** & paddleboarding
- ✓ Lectures & presentations in the lounge
- ✓ Photo instruction
- ✓ Morning stretch classes with wellness specialist

# SPECIAL OFFERS

**FREE AIR OR EXTENSION:** Book by July 31, 2017 and receive free round-trip airfare between Miami and Panama City/Costa Rica, OR a free overnight and sightseeing in Panama City. This includes a private dinner at the Miraflores Locks, city tour, visit to the Frank Gehry-designed Biodiversity Museum, and more. New bookings only; subject to availability. Call for details.

**BRING THE KIDS:** We believe sharing an expedition with your kids or grandkids is a life-enhancing experience. So, take \$500 off the double occupancy price for each person under 18.

# TERMS AND CONDITIONS

**VOYAGE COSTS INCLUDE:** All accommodations aboard ship; all meals and nonalcoholic beverages aboard ship; shore excursions, sightseeing, and entrance fees; use of kayaks **and paddleboards**; special access permit; transfers to and from group flights; tips (except to ship's crew), taxes, and service charges, and services of a ship physician and the expedition staff.

**NOT INCLUDED:** Air transportation (unless otherwise indicated); extensions (unless otherwise indicated); passport, visa, immigration fees; meals not indicated; travel protection plan; items of a personal nature such as alcoholic beverages, e-mail, voyage DVD, laundry.

**AIRFARE:** Airfare is an additional cost (unless otherwise indicated). Lindblad will assist in making your air arrangements for a \$50 per person service fee.

**RESERVATIONS:** To confirm your place, an advance payment of US\$750 per person is payable by check, Visa, MasterCard, American Express, or Discover.

**FINAL PAYMENT:** Due 90 days prior to departure.

**ELIGIBILITY:** We require membership to the Commonwealth Club to travel with us. People who live outside of the Bay Area may purchase a national membership. To learn about membership types and to purchase a membership, visit [commonwealthclub.org](http://commonwealthclub.org)/membership or call (415) 597-6720.

**TRAVEL PROTECTION PLAN:** Information about travel insurance will be sent by the Commonwealth Club upon registration.

**SMOKING POLICY:** Allowed only in designated outdoor areas.

**ENTRY AND VISA REQUIREMENTS:** All guests are advised to verify travel documents (passport/transit visa/entry visa) for the country through which they are transiting and/or entering. Reliable and most current information regarding international travel can be found by contacting the consulate/ embassy of the country(s) you are visiting or transiting through. We will not be responsible if you are denied entry or transit into a Country, if you are unable to

provide valid documents as per the Country's requirement.

**RESPONSIBILITY:** The Commonwealth Club of California and our tour operators and suppliers act only as agents for the travelers with respect to transportation and arrangements, and exercise every care possible in doing so. However, we can assume no liability for injury, damage, loss, accident, delay or irregularity in connection with the service of any automobile, motorcoach, or any other conveyance used in carrying out this program or for the acts or defaults of any company or person engaged in conveying the passenger or in carrying out the arrangements of the program. We cannot accept any responsibility for losses or additional expenses due to delay or changes in air or other services, sickness, weather, strike, war, quarantine, force majeure or other causes beyond our control. All such losses or expenses will have to be borne by the passenger as tour rates provide arrangements only for the time stated. We reserve the right to make such alterations to this published itinerary as may be deemed necessary. The right is reserved to cancel any program prior to departure in which case the entire payment will be refunded without further obligation on our part. No refund will be made for an unused portion of any tour unless arrangements are made in sufficient time to avoid penalties. The Commonwealth Club of California accepts no liability for any carrier's cancellation penalty incurred by the purchase of a nonrefundable ticket in connection with the tour.

Certain other provisions concerning, among other things, limitations of the Company's liability for loss of property, injury, illness or death during the voyage will be provided to all guests prior to final payment, and to prospective guests upon request.

*Prices listed in this brochure are as of publication date, and are subject to change. Lindblad Maritime Enterprises reserves the right to impose surcharges based on increases in the actual cost of fuel.*

<b>CANCELLATION POLICY</b>	
<b>Number of Days Prior to Expedition Start</b>	<b>Per Person Cancellation Fee</b>
120 or more days	\$350
119–90 days	Advance payment cost
89–60 days	25% of trip cost
59–45 days	50% of trip cost
44–0 days	No refund
<i>We strongly recommend that you purchase a travel protection plan.</i>	

PHOTO CREDITS: will be placed here once the brochure is approved and the artwork is final.



## RESERVATION FORM: COSTA RICA & THE PANAMA CANAL

**ABOARD NATIONAL GEOGRAPHIC QUEST—JANUARY 13-20, 2018**

Please send reservation form to: Commonwealth Club Travel,  
PO Box 194210, San Francisco, CA 94119 OR Fax to: 415-597-6729 OR Call: 415-597-6720  
OR E-mail: [travel@commonwealthclub.org](mailto:travel@commonwealthclub.org)

Please reserve \_\_\_\_\_ place(s).

Name 1: \_\_\_\_\_  
*(As it appears on passport)*

Name 1: \_\_\_\_\_ Date of Birth: \_\_\_\_\_  
*(Preferred name for name badge)*

Name 2: \_\_\_\_\_  
*(As it appears on passport)*

Name 2: \_\_\_\_\_ Date of Birth: \_\_\_\_\_  
*(Preferred name for name badge)*

Street Address: \_\_\_\_\_

City: \_\_\_\_\_ State: \_\_\_\_\_ Zip: \_\_\_\_\_

Home Phone: \_\_\_\_\_ Business Phone: \_\_\_\_\_

Cell Phone: \_\_\_\_\_ Fax: \_\_\_\_\_

E-mail: \_\_\_\_\_

Accommodations:  Double  Single  Twin share w/friend

Share with roommate assigned by tour operator

Please indicate choice of cabin category in order of preference:

1st choice: \_\_\_\_\_ 2nd choice: \_\_\_\_\_

Enclosed is my advance payment of \$ \_\_\_\_\_ (\$750 per person).

Check made payable to **Lindblad Maritime Enterprises, Ltd.**

Charge my advance payment of \$ \_\_\_\_\_ (\$750 per person)

to my  VISA  MasterCard or  American Express  Discover.

Account Number: \_\_\_\_\_ Expires: \_\_\_\_\_

Cardholder Signature: \_\_\_\_\_ Date: \_\_\_\_\_

We require membership to The Commonwealth Club to travel with us.

Please check one of the following options:

I am a current member of The Commonwealth Club.

Please renew my membership with the credit card information provided here.

I will visit [commonwealthclub.org/membership](http://commonwealthclub.org/membership) to sign up for a membership.

Commonwealth Club Travel CST #2096889-40

## EXPEDITION HIGHLIGHTS

- » Explore the fascinating lock system of the Panama Canal and enjoy special access to Barro Colorado Nature Monument.
- » See howler and capuchin monkeys, sloths, scarlet macaws, and toucans.
- » Explore the tiny islands of the Gulf of Panama and snorkel off Isla Coiba.
- » Discover hidden pools and waterfalls deep within the jungles of the Osa Peninsula.
- » Travel with expert naturalists and photography pros.



## COMMONWEALTH CLUB

Commonwealth Club Travel  
P.O. Box 194210, San Francisco, CA 94119

PRSR STD  
U.S. POSTAGE  
PAID  
LINDBLAD  
EXPEDITIONS